

OPERATING AND MAINTENANCE MANUAL



WHEEL NUT SOCKETS WITHOUT MAGNETS



Thanks for choosing a PAOLI product.

*Behind your socket you have
the capacity and the diligence of a company team
which is working all the days to be able to offer you
always powerful, reliable and long lasting products.*

*From the Pit Lanes to any businesses,
your success is our goal!*



WHEEL NUT SOCKETS WITHOUT MAGNETS

OPERATING AND MAINTENANCE MANUAL

Safe operation of this socket is possible only when the operating instructions are read completely and the instructions contained therein are strictly observed.

The addresses of these instructions are professionals trained.

THESE INSTRUCTIONS MUST ALWAYS BE WITH THE SOCKET.

KEEP THEM IN A SAFE PLACE.

4

7

ATTACHMENTS

Exploded view and spare parts

TECHNICAL DATA

DESCRIPTION

The wheel nut sockets are designed to be connected direct to motorsport wheel guns, and their function is to be a link between the

wheel gun and the threaded fastener. These sockets don't use magnets to retaining the wheel nut.

PRODUCT CODE	SQUARE DRIVE	MATERIAL	BEST PRACTICE
B.28.0052	1"	Aluminium*	Porsche 991 Cup
B.28.0037	1"	Aluminium*	Ferrari 430 Challenge
B.28.0058**	1"	Titanium	F488
B.28.0051**		Aluminium	
B.28.0062	1"	Steel	Super Formula
B.28.0061	1"	Titanium	Formula 2
B.28.0034	1"	Steel	GP3 WSR F3
B.28.0035	3/4"		
B.28.0059	1"	Steel	Mercedes AMG GT3R
B.28.0098	1"	Titanium	

*Only for torque wrench application

** 24 teeth

WHEEL NUT SOCKETS IDENTIFICATION DATA

The wheel nut socket has these marks:

- Product Code
- Serial Number

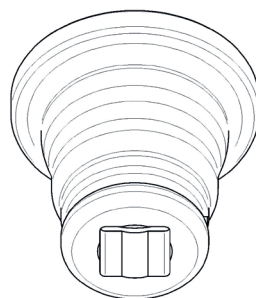
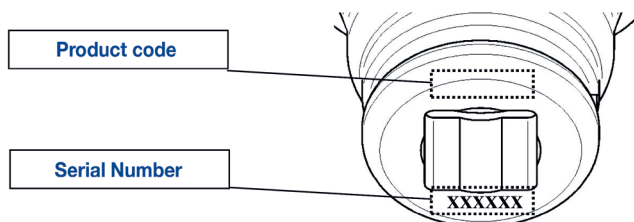

STEPS TO ASSEMBLY

STEP 1

Place the wheel nut socket in the square drive of the wheel gun (view figure Fig.1). Always check that the hole of the socket is corresponding with the hole in the square drive of the wheel gun.

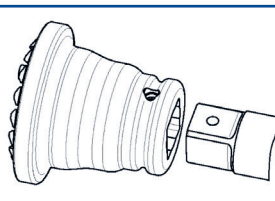

Fig. 1

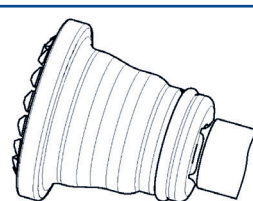

Fig. 3

STEP 2

Insert the locking pin (view point 3, figure Fig. 2) in transverse hole of the wheel nut socket. Pay attention to the insertion position.

STEP 3

By using a pliers, place the retaining ring (view point 2, figure Fig. 2) for bore in the seat formed in the hole where the locking pin (view point 3, figure Fig. 2) was positioned, to prevent it from escaping (view detail A, figure Fig. 2)

STEP 4

Place the retaining O-ring (view point 1, figure Fig. 2) in the housing on the collar of the wheel nut socket (view figure Fig.3).

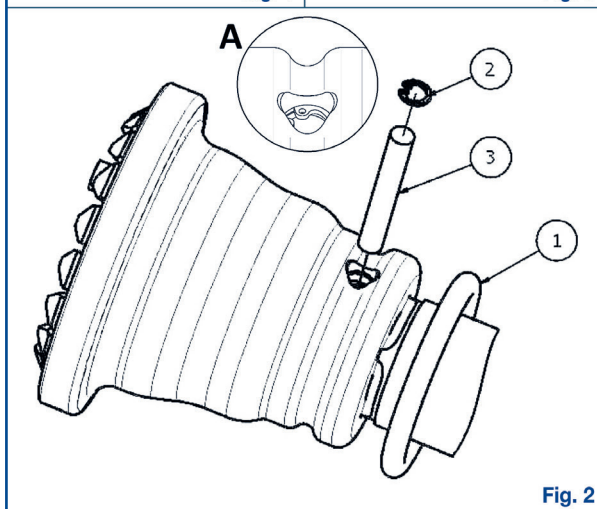

Fig. 2



The above mentioned operations must be done by specialised staff.

Original operating instructions - The original language of these instructions is English.



SAFETY INSTRUCTIONS

- ▷ Before using, ensure the markings on socket correspond with application.
- ▷ Always wear safety glasses, while using sockets.
- ▷ Don't touch the sockets whilst in use. Always use approved protections suitable for their intended use.
- ▷ Before every race it is strongly recommended to check:
 - the wear and cleaning of socket. If it is having cracks, dents, and deformations, the socket must be replaced.
 - the wear of the front ring. Replace it with an appropriate one if it shows signs of wear. (ove presenti)
 - the wear of the spring plungers. Replace them with an appropriate one if they show signs of wear.
- ▷ Always use socket of the same size as the wheel nut. Don't use larger sizes or force a socket on a nut.
- ▷ Never use the socket without the retaining system (locking pin, retainer ring and retaining O-ring). The socket without the retainer can be dangerous if it gets out during the work.
- ▷ Always use the socket with the retainers provided with the square drive of the wheel gun. Always check that pin and retainer ring are perfectly in their seats and that the dimensions are correct.
- ▷ Replace the retainer ring every time when disassembling.
- ▷ Do not alter any element of the socket. Any alterations to the socket must be approved by the manufacturing company's responsible engineers due to reasons regarding liability and operating safety.
- ▷ Use only genuine spare parts and authorized service organizations.
- ▷ Ship the wheel nut socket back to the PAOLI facilities at least once per year for complete overhauling.

EXPLODED VIEW AND SPARE PARTS

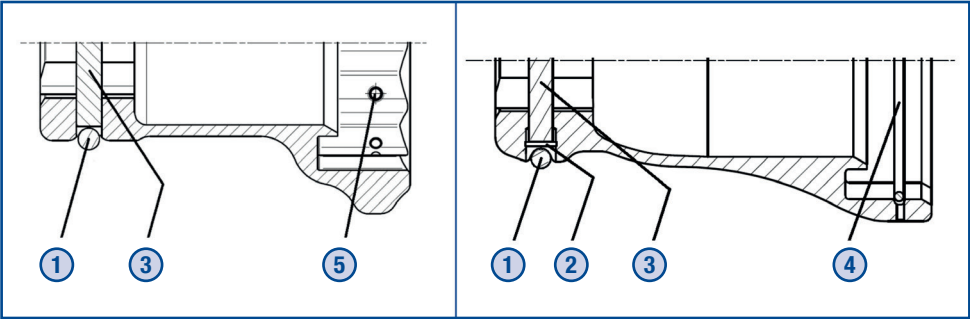

FOR SOCKETS	① RETAINING O-RING	② CIRCLIP	③ RETAINERS	④ FRONT RING	⑤ SPRING PLUNGERS
B.28.0052	B.30.02.0004	D.09.08.0043	B.30.01.0014	M.12.04.0001 (204 mm)	—
B.28.0037	B.30.02.0005	—	B.30.01.0009	—	B.30.05.0004
B.28.0051 B.28.0058	B.30.02.0004	D.09.08.0043	B.30.01.0014	—	—
B.28.0062	B.30.02.0008	D.09.08.0043	B.30.01.0014	B.30.05.0006	—
B.28.0061	B.30.02.0004	D.09.08.0043	B.30.01.0014	B.30.05.0006	—
B.28.0034	B.30.02.0008	—	B.30.01.0014	—	B.30.05.0005
B.28.0035	B.30.02.0003	—	B.30.01.0001	—	B.30.05.0003
B.28.0059	B.30.02.0004	D.09.08.0043	B.30.01.0014	—	—
B.28.0098	B.30.02.0004	D.09.08.0043	B.30.01.0014	—	—



DINO PAOLI s.r.l.
Via G. Dorso, 5 - 42124 Reggio nell'Emilia (RE) - Italy
Phone +39 0522 364 511 - Fax +39 0522 304 864
info@paoli.net - www.paoli.net