

# NUTRUNNERS

## AVVITATORI A BRACCIO DI REAZIONE PNEUMATICI 3/4"-1"-1 1/2"



Product name <i>Nome prodotto</i>	DP05-34	DP10-34	DP20-10	DP30-10	DP36-10	DP48-15
Product code <i>Codice prodotto</i>	A.06.0009	A.06.0010	A.06.0011	A.06.0012	A.06.0013	A.06.0015
Square drive <i>Attacco quadro</i>	3/4"	3/4"	1"	1"	1"	1 1/2"
Bolt range <i>Capacità bullone</i>	M20	M24	M33	M36	M39	M52
Torque range <i>Campo di coppia</i>	125-500 Nm 90-370 ft-lb	250-1000 Nm 190-740 ft-lb	380-2000 Nm 300-1480 ft-lb	580-3000 Nm 450-2220 ft-lb	760-3600 Nm 600-2660 ft-lb	500-4800 Nm 370-3540 ft-lb
Max pressure <i>Pressione max</i>	6 bar 87 psi	6 bar 87 psi	6 bar 87 psi	6 bar 87 psi	6 bar 87 psi	6 bar 87 psi
Speed <i>Velocità</i>	55 rpm	27,5 rpm	7,2 rpm	4,2 rpm	3,6 rpm	12,9 rpm
Weight <i>Peso</i>	4,7 kg 10.4 lbs	4,9 kg 10.8 lbs	6,0 kg 13.2 lbs	6,6 kg 14.5 lbs	6,6 kg 14.5 lbs	8,5 kg 18.7 lbs
Air inlet <i>Ingresso aria</i>	1/4" BSP	1/4" BSP	1/4" BSP	1/4" BSP	1/4" BSP	1/4" BSP
Inner hose diameter <i>Diametro interno tubo</i>	8 mm 0.315 in	8 mm 0.315 in	8 mm 0.315 in	8 mm 0.315 in	8 mm 0.315 in	8 mm 0.315 in
Length <i>Lunghezza</i>	281 mm 11.06 in	297 mm 11.69 in	321 mm 12.64 in	337 mm 13.27 in	337 mm 13.27 in	437 mm 17.2 in

### REACTION ARM BRACCIO DI REAZIONE

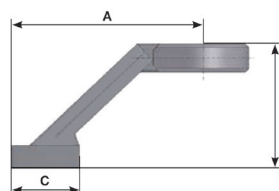

Available for <i>Disponibile per</i>	DP05-34	DP10-34	DP20-10	DP30-10	DP36-10
A	184 mm 7.24 in	184 mm 7.24 in	190 mm 7.48 in	230 mm 9.06 in	230 mm 9.06 in
B	100 mm 3.94 in	100 mm 3.94 in	100 mm 3.94 in	110 mm 4.33 in	110 mm 4.33 in
C	90 mm 3.54 in	90 mm 3.54 in	90 mm 3.54 in	90 mm 3.54 in	90 mm 3.54 in
Weight <i>Peso</i>	1.5 kg 3.30 lb	1.5 kg 3.30 lb	1.85 kg 4.08 lb	2.4 kg 5.29 lb	2.5 kg 5.51 lb

### MAIN FEATURES CARATTERISTICHE PRINCIPALI

#### ANVIL TYPE TIPO ALBERO



With hole, without ring  
*Con foro, senza anello*

#### AIR EXHAUST DIRECTION DIREZIONE SCARICO ARIA



Through the handle  
*Impugnatura*

### BEST FOR APPLICAZIONI



Industrial assembly  
*Montaggi industriali*



Heavy vehicles  
*Mezzi pesanti*

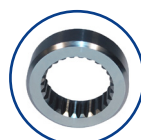

### AVAILABLE DISPONIBILE

Chained ring available on demand  
*Anello calettato disponibili su richiesta*

Controlled torque tightening  
*Serraggio a coppia controllata*

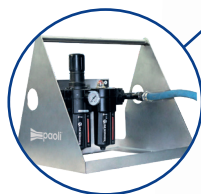

Air treatment for nutrunners  
available (pag. 129)  
*Gruppo trattamento aria  
disponibile (pag. 129)*



Light weight  
*Leggero*

Minimum vibration level  
*Vibrazioni minime*

Heavy duty handle available for  
industrial applications  
*Disponibile impugnatura heavy  
duty per applicazioni industriali*

Standard reaction arm included  
*Braccio di reazione standard incluso*

Torque calibration table included  
*Tabella di calibrazione di coppia inclusa*

Tools for arm mounting and fixing are included  
*Strumenti per montaggio e fissaggio braccio inclusi*

Other reaction arms available on request  
*Altri bracci di reazione disponibili su richiesta*