



ELECTRONICS  
KIT UPGRADE  
READY

# DP 6000 SPLINE

## BEST PRACTICE

INDYCAR / ENDURANCE

From **PAOLI'S EXPERIENCE** and its cutting edge sectorial engineering research a new wheel gun is born: the **SPLINE DRIVE DP 6000**. The work in R&D of the Paoli highly skilled technicians and the partnership with the most recognized racing teams has allowed the development of an innovative and greatly performing product.

A spline drive wheel gun differs from a square drive tool mainly in the teeth that connect the anvil with the socket.

Spline drive wheel guns, because of the increased contact points between the anvil and the socket, offer a better torque transmission and a reduced load on each contact point.

This means the following **ADVANTAGES**: more power; more strength; more endurance.

Paoli supplies spline sockets to be used with **DP 6000 SPLINE**.

PRODUCT NAME	FRONT COVER TYPE	VERSION	PRODUCT CODE
DP 6000 SPLINE 90° ANGLED HANDLE	Carbon Cover	LH	006000.00051
		RH	006000.00052
		UH	006000.00053
	Aerospace 7075 aluminium alloy	LH	006000.00048
		RH	006000.00049
		UH	006000.00050
DP 6000 SPLINE CLASSIC HANDLE	Carbon Cover	LH	006000.00057
		RH	006000.00058
		UH	006000.00059
	Aerospace 7075 aluminium alloy	LH	006000.00054
		RH	006000.00055
		UH	006000.00056

(2 port available on demand)

## AVAILABLE VERSIONS



Fast left hand version:  
loosens nuts tightened  
clockwise faster



Fast right hand version:  
loosens nuts tightened  
anticlockwise faster



Special unhandled version:  
loosens at same speed both  
the nuts tightened clockwise  
and anticlockwise

### NEW RADIAL HAMMER MECHANISM (RHM) INSIDE!

The new radial hammer mechanism guarantees a superior performance and a longer lifespan of the hammer mechanism parts, thanks to the new developed geometry.



**NEW OPTIONAL!**  
TO INCREASE DURABILITY AND STRENGTH

### NEW OPTIONAL MONOLITHIC PIN



## HIGHLIGHTS

- Paoli patent pending profile
- Cutting edge anvil-socket fixing system



New Paoli  
spline drive anvil



Traditional  
square drive anvil

### SPLINE ANVIL

Advantages:

- More efficient connection than traditional square drive anvil thanks to the elimination of gap and vibrations
- More durability due to less wear
- More comfort and safety for the operator thanks to the removal of the pin

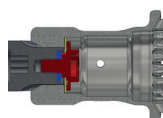

### NEW ANVIL-SOCKET FIXING SYSTEM!

The wheel nut socket is connected to the anvil by a cutting edge fixing screw system.



**NEW  
ALLUMINIUM BODY!**  
Stronger and more  
durable!

## MANUAL



Operating and  
Maintenance  
Manual



WWW.PAOLI.NET | SALES@PAOLI.NET | +39.0522.364511