

DP 93

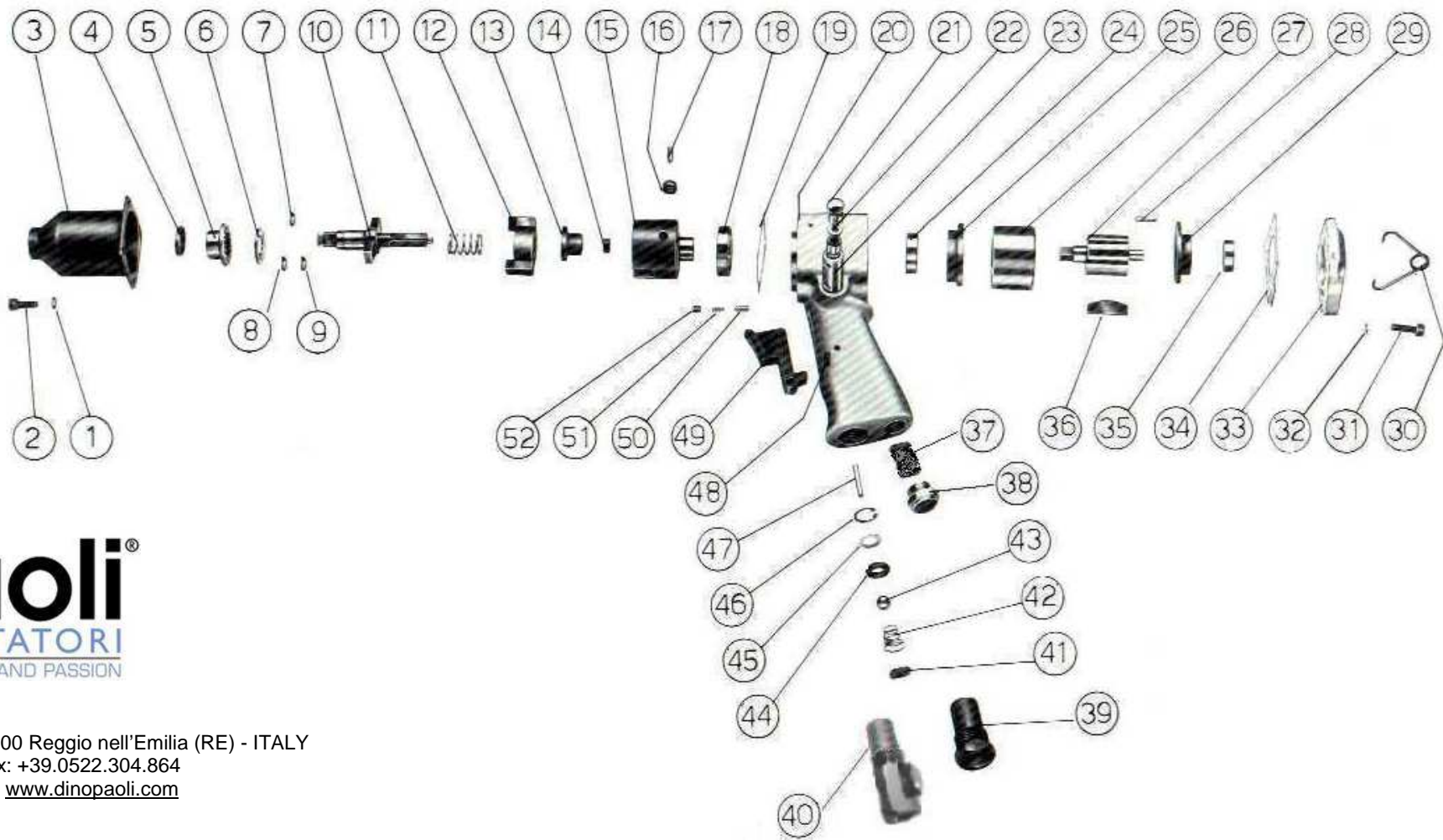

Dino Paoli s.r.l. - Via G. Dorso, 5 - 42100 Reggio nell'Emilia (RE) - ITALY
 Tel.: +39.0522.364.511 / 300.828 - Fax: +39.0522.304.864
 E-mail: info@dinopaoli.com - Website: www.dinopaoli.com

- | | | | |
|--|-----------------------------------|-------------------------------------|--|
| 1 Hammer Case Lock Washer | 17 Pin Roller | 33 Housing Cover | 49 Trigger |
| 2 Hammer case Cap Screw | 18 Clutch Housing Bearing | 34 Housing Cover Gasket | 50 Rotation Reverser Pin |
| 3 Hammer Case | 19 Hammer Case Gasket | 35 Rear Rotor Bearing | 51 Rotation Reverser Spring |
| 4 Hammer Case Oil Seal | 20 Motor Housing | 36 Vane | 52 Rotation Reverser Grub Screw |
| 5 Combined Bearing | 21 Rotation Reverse Shaft Seal | 37 Muffler Foam | A Whole Motor Housing (20+23;39;41+52) |
| 6 Thrust Plate | 22 Rotation Reverse Shaft | 38 Silencer | B Whole Motor Housing + Reg. (20+23;40+52) |
| 7 ½" Socket Retainer (alternative 8;9) | 23 Rotation Reverse Shaft Bushing | 39 Air Inlet Reducer | C Whole Hammer Case (3;4;5) |
| 8 ½" Socket Retaining Ring | 24 Front Rotor Bearing | 40 Air Inlet Reducer with Regulator | D Front End Plate + Bearing (24;25) |
| 9 ½" Socket Retainer O-ring | 25 Front End Plate | 41 Air Filter | E Rear End Plate + Bearing (29;35) |
| 10 Anvil Shank (½"sq. drive) | 26 Cylinder | 42 Valve Spring | F Air Inlet Valve (39;41+46) |
| 11 Clutch Spring | 27 Rotor | 43 Stainless Ball | G Air Inlet Valve + Regulator (40+46) |
| 12 Clutch Plate | 28 Cylinder Dowel | 44 Valve Seat | H Anvil Shank +Ring +O-ring (8;9;10) |
| 13 Clutch Cam | 29 Rear End Plate | 45 Valve Seat Support | I Anvil Shank +Ring (7;10) |
| 14 Clutch Housing Bushing | 30 Hanger | 46 Anchor Pin Circlip | |
| 15 Clutch Housing | 31 Housing Cover Screw | 47 Valve Pin | |
| 16 Roller | 32 Housing Cover Lock Washer | 48 Trigger Pin | |