

DP 92 XC

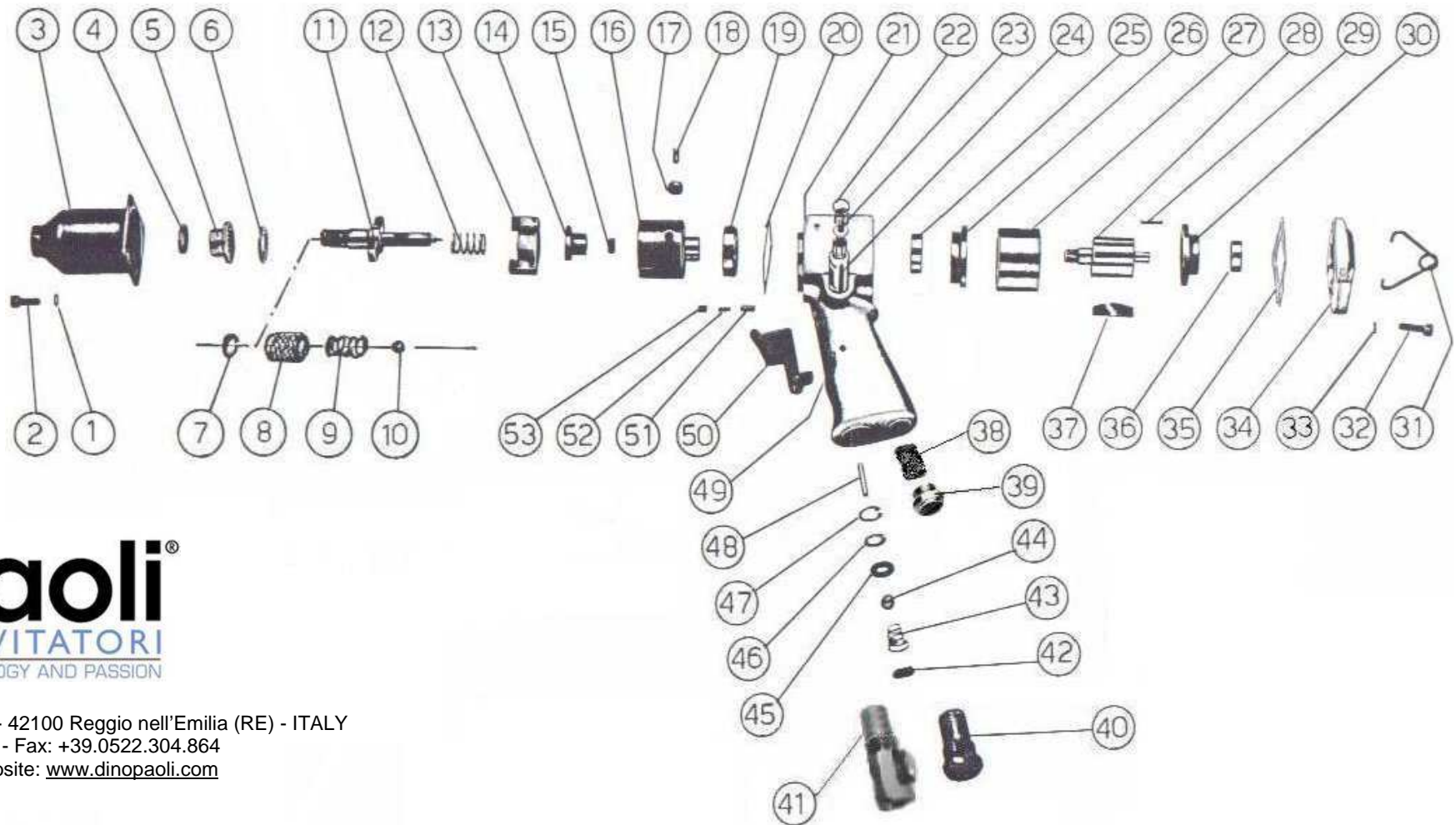

Dino Paoli s.r.l. - Via G. Dorso, 5 - 42100 Reggio nell'Emilia (RE) - ITALY
 Tel.: +39.0522.364.511 / 300.828 - Fax: +39.0522.304.864
 E-mail: info@dinopaoli.com - Website: www.dinopaoli.com

- | | | | |
|---------------------------|-----------------------------------|-------------------------------------|--|
| 1 Hammer Case Lock Washer | 17 Roller | 33 Housing Cover Lock Washer | 49 Trigger Pin |
| 2 Hammer Case Cap Screw | 18 Pin Roller | 34 Housing Cover | 50 Trigger |
| 3 Hammer Case | 19 Clutch Housing Bearing | 35 Housing Cover Gasket | 51 Rotation Reverser Pin |
| 4 Hammer Case Oil Seal | 20 Hammer Case Gasket | 36 Rear Rotor Bearing | 52 Rotation Reverser Spring |
| 5 Combined Bearing | 21 Motor Housing | 37 Vane | 53 Rotation Reverser Grub Screw |
| 6 Thrust Plate | 22 Rotation Reverse Shaft Seal | 38 Muffler Foam | A Whole Motor Housing (21÷24;40;42÷53) |
| 7 Retainer Ring | 23 Rotation Reverse Shaft | 39 Silencer | B Whole Motor Housing + Reg. (21÷24;41÷53) |
| 8 Jacket | 24 Rotation Reverse Shaft Bushing | 40 Air Inlet Reducer | C Whole Hammer Case (3;4;5) |
| 9 Jacket Spring | 25 Front Rotor Bearing | 41 Air Inlet Reducer with Regulator | D Front End Plate + Bearing (25;26) |
| 10 Stainless Ball | 26 Front End Plate | 42 Air Filter | E Rear End Plate + Bearing (30;36) |
| 11 Spindle | 27 Cylinder | 43 Valve Spring | F Air Inlet Valve (40;42÷47) |
| 12 Clutch Spring | 28 Rotor | 44 Stainless Ball | G Air Inlet Valve + Regulator (41÷47) |
| 13 Clutch Plate | 29 Cylinder Dowel | 45 Valve Seat | H Tool Kit (7;8;9;10) |
| 14 Clutch Cam | 30 Rear End Plate | 46 Valve Seat Support | |
| 15 Clutch Housing Bushing | 31 Hanger | 47 Anchor Pin Circlip | |
| 16 Clutch Housing | 32 Housing Cover Screw | 48 Valve Pin | |