

DP 33 SS

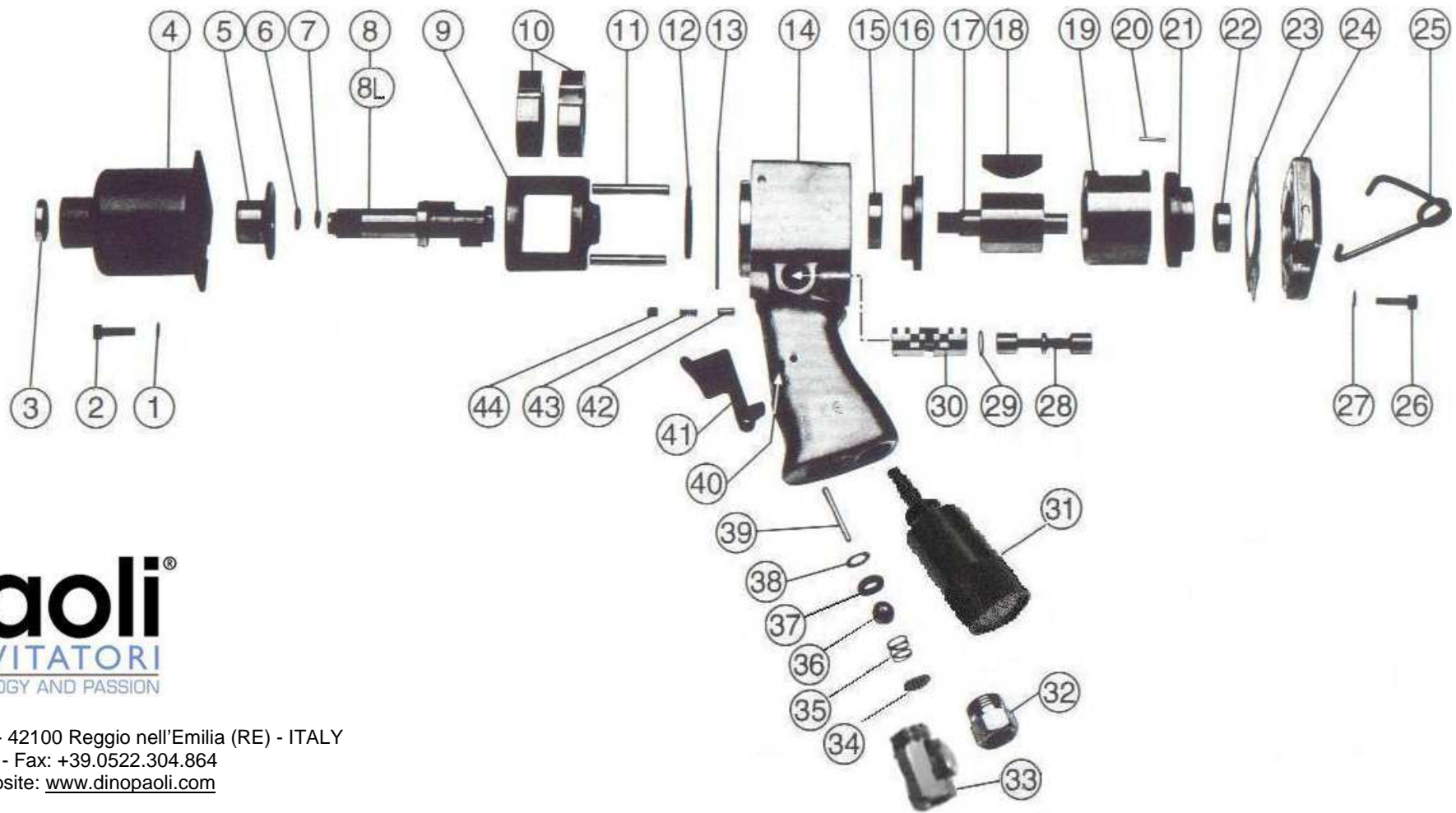

Dino Paoli s.r.l. - Via G. Dorso, 5 - 42100 Reggio nell'Emilia (RE) - ITALY
 Tel.: +39.0522.364.511 / 300.828 - Fax: +39.0522.304.864
 E-mail: info@dinopaoli.com - Website: www.dinopaoli.com

- | | | | |
|---|------------------------------|-------------------------------------|--|
| 1 Hammer Case Lock Washer | 14 Motor Housing | 28 Rotation Reverse Shaft | 42 Rotation Reverser Pin |
| 2 Hammer Case Cap Screw | 15 Front Rotor Bearing | 29 Rotation Reverse Shaft Seal | 43 Rotation Reverser Spring |
| 3 Hammer Case Oil Seal | 16 Front End Plate | 30 Rotation Reverse Shaft Bushing | 44 Rotation Reverser Grub Screw |
| 4 Hammer Case | 17 Rotor | 31 Special Silencer | A Whole Motor Housing (14;28+30;34;36+46) |
| 5 Hammer Case Bushing | 18 Vane | 32 Air Inlet Reducer | B Whole Motor Housing + Reg.(14;28+30;35+46) |
| 6 1/2" Socket Retaining Ring | 19 Cylinder | 33 Air Inlet Reducer with Regulator | C Whole Hammer Case (3;4;5) |
| 7 1/2" Socket Retainer O-ring | 20 Cylinder Dowel | 34 Air Filter | D Front End Plate + Bearing (15;16) |
| 8 Standard Anvil Shank (1/2"sq. drive) | 21 Rear End Plate | 35 Valve Spring | E Rear End Plate + Bearing (21;22) |
| 8L Extended Anvil Shank (1/2"sq. drive) | 22 Rear Rotor Bearing | 36 Stainless Ball | F Anvil Shank +Ring +O-ring (6;7;8/8L) |
| 9 Hammer Frame | 23 Housing Cover Gasket | 37 Valve Seat | |
| 10 Hammer | 24 Housing Cover | 38 Valve Seat Support | |
| 11 Hammer Pin | 25 Hanger | 39 Valve Pin | |
| 12 Hammer Frame Rear Washer | 26 Housing Cover Screw | 40 Trigger Pin | |
| 13 Hammer Case Gasket | 27 Housing Cover Lock Washer | 41 Trigger | |