

# DP 33

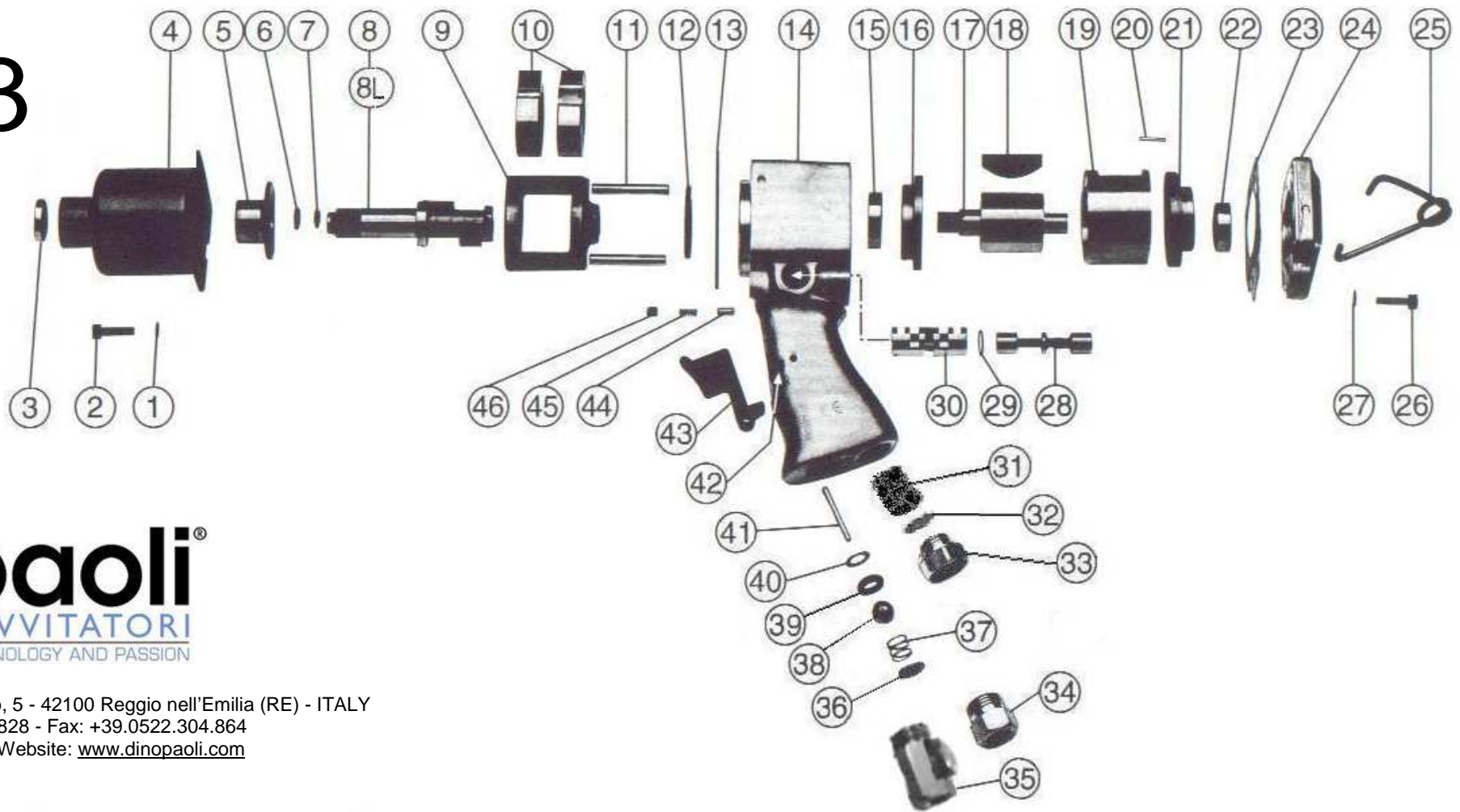

Dino Paoli s.r.l. - Via G. Dorso, 5 - 42100 Reggio nell'Emilia (RE) - ITALY  
 Tel.: +39.0522.364.511 / 300.828 - Fax: +39.0522.304.864  
 E-mail: [info@dinopaoli.com](mailto:info@dinopaoli.com) - Website: [www.dinopaoli.com](http://www.dinopaoli.com)

- |    |                                      |    |                           |    |                                  |    |  |
|----|--------------------------------------|----|---------------------------|----|----------------------------------|----|--|
| 1  | Hammer Case Lock Washer              | 14 | Motor Housing             | 28 | Rotation Reverse Shaft           | 42 | Trigger Pin                                |
| 2  | Hammer Case Cap Screw                | 15 | Front Rotor Bearing       | 29 | Rotation Reverse Shaft Seal      | 43 | Trigger                                    |
| 3  | Hammer Case Oil Seal                 | 16 | Front End Plate           | 30 | Rotation Reverse Shaft Bushing   | 44 | Rotation Reverser Pin                      |
| 4  | Hammer Case                          | 17 | Rotor                     | 31 | Muffler Foam                     | 45 | Rotation Reverser Spring                   |
| 5  | Hammer Case Bushing                  | 18 | Vane                      | 32 | Silencer Air Filter              | 46 | Rotation Reverser Grub Screw               |
| 6  | 1/2" Socket Retaining Ring           | 19 | Cylinder                  | 33 | Silencer                         | A  | Whole Motor Housing (14;28+30;34;36+46)    |
| 7  | 1/2" Socket Retainer O-ring          | 20 | Cylinder Dowel            | 34 | Air Inlet Reducer                | B  | Whole Motor Housing +Reg. (14;28+30;35+46) |
| 8  | Standard Anvil Shank (1/2"sq. drive) | 21 | Rear End Plate            | 35 | Air Inlet Reducer with Regulator | C  | Whole Hammer Case (3;4;5)                  |
| 8L | Extended Anvil Shank (1/2"sq. drive) | 22 | Rear Rotor Bearing        | 36 | Air Filter                       | D  | Front End Plate + Bearing (15;16)          |
| 9  | Hammer Frame                         | 23 | Housing Cover Gasket      | 37 | Valve Spring                     | E  | Rear End Plate + Bearing (21;22)           |
| 10 | Hammer                               | 24 | Housing Cover             | 38 | Stainless Ball                   | F  | Anvil Shank +Ring +O-ring (6;7;8/8L)       |
| 11 | Hammer Pin                           | 25 | Hanger                    | 39 | Valve Seat                       |    |  |
| 12 | Hammer Frame Rear Washer             | 26 | Housing Cover Screw       | 40 | Valve Seat Support               |    |  |
| 13 | Hammer Case Gasket                   | 27 | Housing Cover Lock Washer | 41 | Valve Pin                        |    |  |