

# DP 197

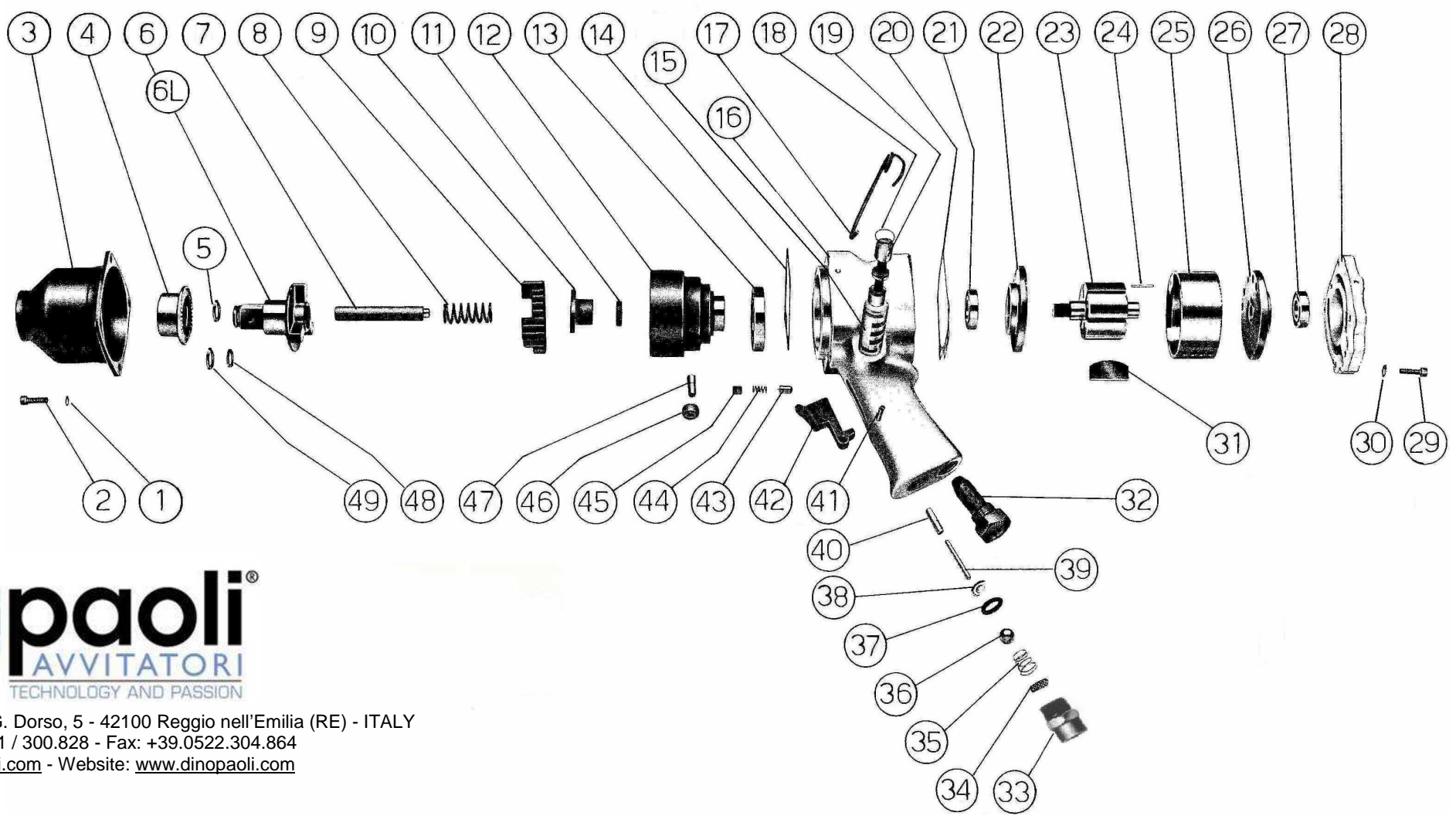

Dino Paoli s.r.l. - Via G. Dorso, 5 - 42100 Reggio nell'Emilia (RE) - ITALY  
 Tel.: +39.0522.364.511 / 300.828 - Fax: +39.0522.304.864  
 E-mail: [info@dinopaoli.com](mailto:info@dinopaoli.com) - Website: [www.dinopaoli.com](http://www.dinopaoli.com)

- |    |                                          |    |                                |    |                           |    |                                         |
|----|------------------------------------------|----|--------------------------------|----|---------------------------|----|-----------------------------------------|
| 1  | Hammer Case Lock Washer                  | 14 | Hammer Case Gasket             | 28 | Housing Cover             | 42 | Trigger                                 |
| 2  | Hammer Case Cap Screw                    | 15 | Rotation Reverse Shaft Bushing | 29 | Housing Cover Screw       | 43 | Rotation Reverser Pin                   |
| 3  | Hammer Case                              | 16 | Motor Housing                  | 30 | Housing Cover Lock Washer | 44 | Rotation Reverser Spring                |
| 4  | Combined Bearing                         | 17 | Hanger                         | 31 | Vane                      | 45 | Rotation Reverser Grub Screw            |
| 5  | 3/4" Socket Retainer (alternative 48;49) | 18 | Rotation Reverse Shaft Seal    | 32 | Silencer                  | 46 | Roller                                  |
| 6  | Standard Anvil Shank (3/4"sq. drive)     | 19 | Rotation Reverse Shaft         | 33 | Air Inlet Reducer         | 47 | Pin Roller                              |
| 6L | Extended Anvil Shank (3/4"sq. drive)     | 20 | Housing Cover Gasket           | 34 | Air Filter                | 48 | 3/4" Socket Retainer O-ring             |
| 7  | Clutch Shaft                             | 21 | Front Rotor Bearing            | 35 | Valve Spring              | 49 | 3/4" Socket Retaining Ring              |
| 8  | Clutch Spring                            | 22 | Front End Plate                | 36 | Stainless Ball            | A  | Whole Motor Housing (15;16;18;19;33+45) |
| 9  | Clutch Plate                             | 23 | Rotor                          | 37 | Valve Seat                | B  | Whole Hammer Case (3;4)                 |
| 10 | Clutch Cam                               | 24 | Cylinder Dowel                 | 38 | Valve Seat Support        | C  | Front End Plate + Bearing (21;22)       |
| 11 | Clutch Housing Bushing                   | 25 | Cylinder                       | 39 | Valve Pin                 | D  | Rear End Plate + Bearing (26;27)        |
| 12 | Clutch Housing                           | 26 | Rear End Plate                 | 40 | Valve Pin Bushing         | E  | Anvil Shank +Ring +O-ring (6/6L;48;49)  |
| 13 | Clutch Housing Bearing                   | 27 | Rear Rotor Bearing             | 41 | Trigger Pin               | F  | Anvil Shank +Ring (5;6/6L)              |