

# DP 176

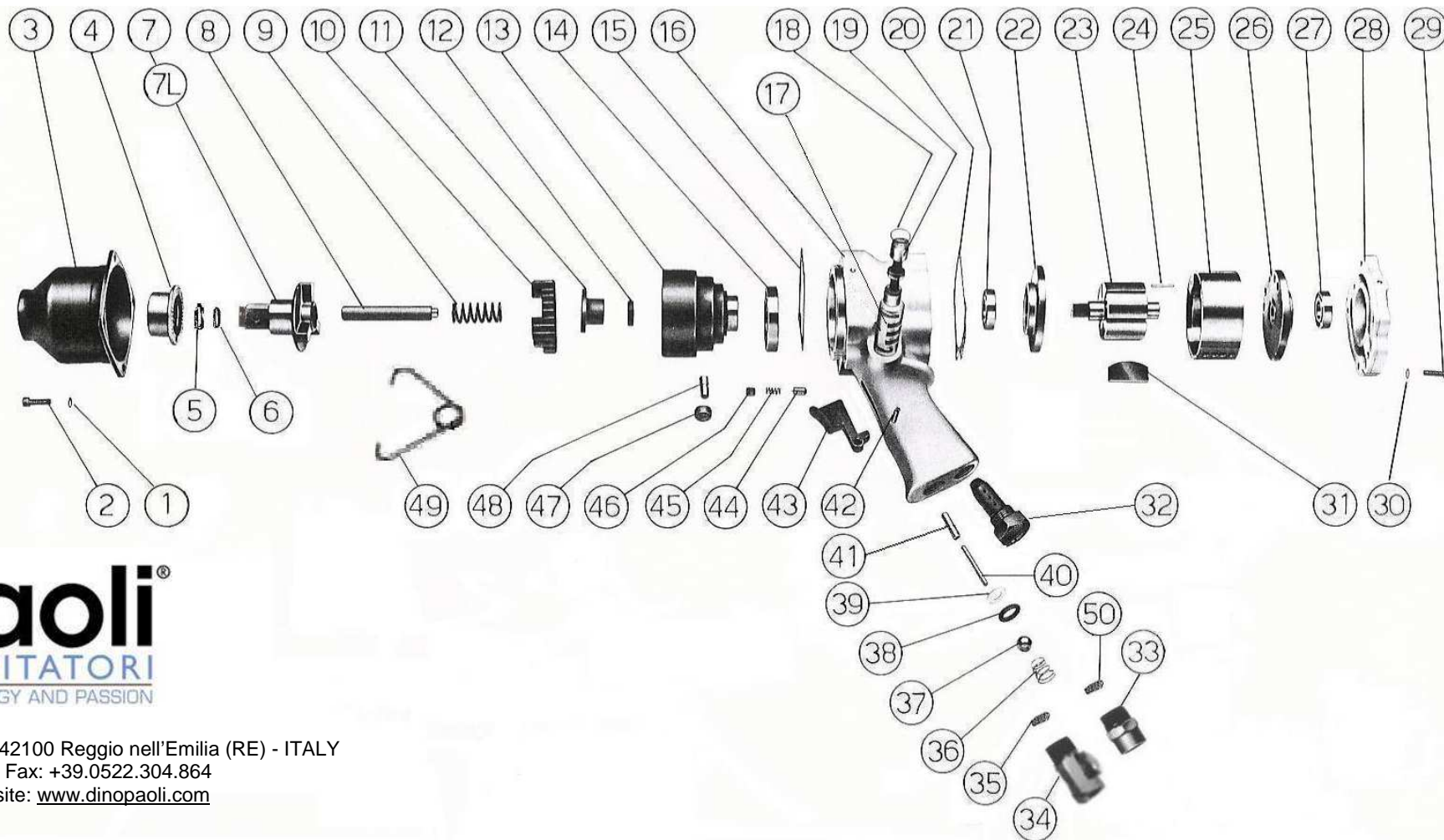

Dino Paoli s.r.l. - Via G. Dorso, 5 - 42100 Reggio nell'Emilia (RE) - ITALY  
 Tel.: +39.0522.364.511 / 300.828 - Fax: +39.0522.304.864  
 E-mail: [info@dinopaoli.com](mailto:info@dinopaoli.com) - Website: [www.dinopaoli.com](http://www.dinopaoli.com)

1	Hammer Case Lock Washer	15	Hammer Case Gasket	30	Housing Cover Lock Washer	45	Rotation Reverser Spring
2	Hammer Case Cap Screw	16	Motor Housing	31	Vane	46	Rotation Reverser Grub Screw
3	Hammer Case	17	Rotation Reverse Shaft Bushing	32	Silencer	47	Roller
4	Combined Bearing	18	Rotation Reverse Shaft Seal	33	Air Inlet Reducer	48	Pin Roller
5	3/4" Socket Retaining Ring	19	Rotation Reverse Shaft	34	Air Inlet Reducer with Regulator	49	Hanger
6	3/4" Socket Retainer O-ring	20	Housing Cover Gasket	35	Air Filter	50	Air Filter
7	Standard Anvil Shank (3/4"sq. drive)	21	Front Rotor Bearing	36	Valve Spring	A	Whole Motor Housing (16+19;33;36+46;50)
7L	Extended Anvil Shank (3/4"sq. drive)	22	Front End Plate	37	Stainless Ball	B	Whole Motor Housing + Reg. (16+19;34+46)
8	Clutch Shaft	23	Rotor	38	Valve Seat	C	Whole Hammer Case (3;4)
9	Clutch Spring	24	Cylinder Dowel	39	Valve Seat Support	D	Front End Plate + Bearing (21;22)
10	Clutch Plate	25	Cylinder	40	Valve Pin	E	Rear End Plate+ Bearing (26;27)
11	Clutch Cam	26	Rear End Plate	41	Valve Pin Bushing	F	Anvil Shank +Ring +O-ring (5;6;7/7L)
12	Clutch Housing Bushing	27	Rear Rotor Bearing	42	Trigger Pin	G	Air Inlet Reducer with Air Filter (33;50)
13	Clutch Housing	28	Housing Cover	43	Trigger		
14	Clutch Housing Bearing	29	Housing Cover Screw	44	Rotation Reverser Pin		