

# DP 123

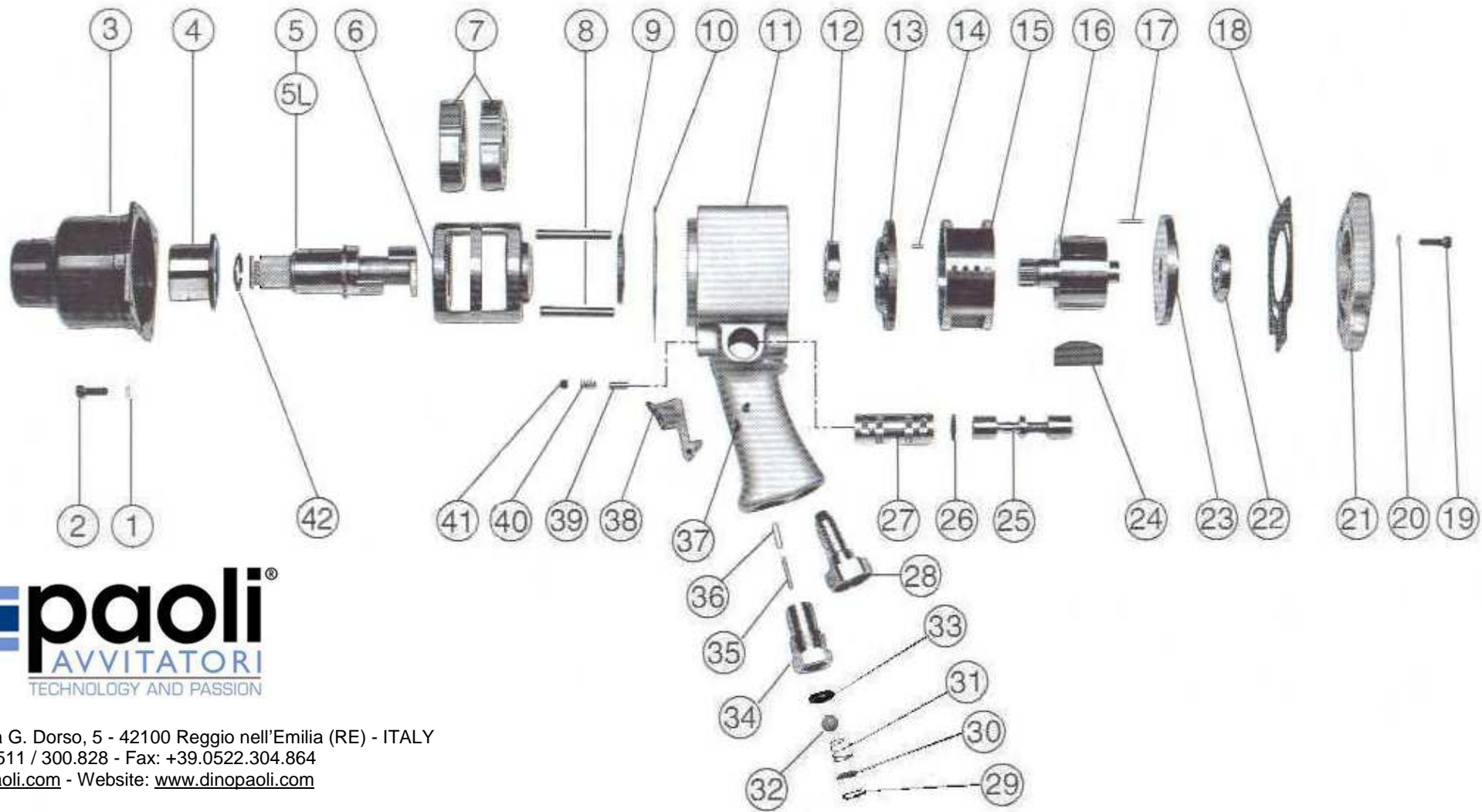

Dino Paoli s.r.l. - Via G. Dorso, 5 - 42100 Reggio nell'Emilia (RE) - ITALY  
 Tel.: +39.0522.364.511 / 300.828 - Fax: +39.0522.304.864  
 E-mail: [info@dinopaoli.com](mailto:info@dinopaoli.com) - Website: [www.dinopaoli.com](http://www.dinopaoli.com)

- |    |                                    |    |                           |    |                                |    |                                      |
|----|------------------------------------|----|---------------------------|----|--------------------------------|----|--------------------------------------|
| 1  | Hammer Case Lock Washer            | 13 | Front End Plate           | 26 | Rotation Reverse Shaft Seal    | 39 | Rotation Reverser Pin                |
| 2  | Hammer Case Cap Screw              | 14 | Front Cylinder Dowel      | 27 | Rotation Reverse Shaft Bushing | 40 | Rotation Reverser Spring             |
| 3  | Hammer Case                        | 15 | Cylinder                  | 28 | Silencer                       | 41 | Rotation Reverser Grub Screw         |
| 4  | Hammer Case Bushing                | 16 | Rotor                     | 29 | Anchor Pin Circlip             | 42 | 1" Socket Retainer                   |
| 5  | Standard Anvil Shank (1"sq. drive) | 17 | Rear Cylinder Dowel       | 30 | Air Filter                     | A  | Whole Motor Housing (11;25+27;29+41) |
| 5L | Extended Anvil Shank (1"sq. drive) | 18 | Housing Cover Gasket      | 31 | Valve Spring                   | B  | Whole Hammer Case (3;4)              |
| 6  | Hammer Frame                       | 19 | Housing Cover Screw       | 32 | Stainless Ball                 | C  | Front End Plate + Bearing (12;13)    |
| 7  | Hammer                             | 20 | Housing Cover Lock Washer | 33 | Valve Seat                     | D  | Rear End plate + Bearing (22;23)     |
| 8  | Hammer Pin                         | 21 | Housing Cover             | 34 | Air Inlet Reducer              | E  | Air Inlet Valve (29+34)              |
| 9  | Hammer Frame Rear Washer           | 22 | Rear Rotor Bearing        | 35 | Valve Pin                      | F  | Anvil Shank +Ring (5/5L;42)          |
| 10 | Hammer Case Gasket                 | 23 | Rear End Plate            | 36 | Valve Pin Bushing              |    |                                      |
| 11 | Motor Housing                      | 24 | Vane                      | 37 | Trigger Pin                    |    |                                      |
| 12 | Front Rotor Bearing                | 25 | Rotation Reverse Shaft    | 38 | Trigger                        |    |                                      |