

# DP 122

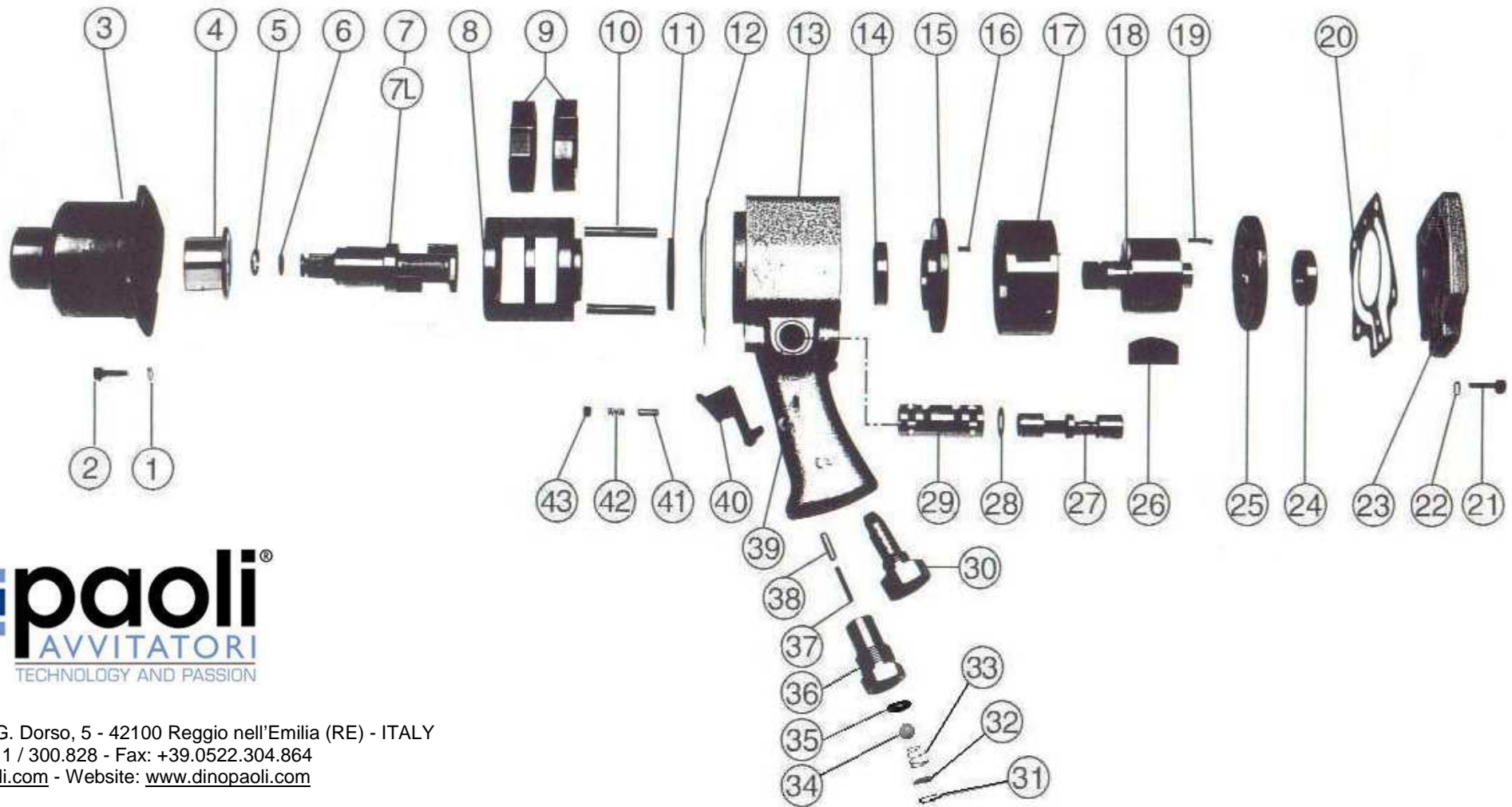

Dino Paoli s.r.l. - Via G. Dorso, 5 - 42100 Reggio nell'Emilia (RE) - ITALY  
 Tel.: +39.0522.364.511 / 300.828 - Fax: +39.0522.304.864  
 E-mail: [info@dinopaoli.com](mailto:info@dinopaoli.com) - Website: [www.dinopaoli.com](http://www.dinopaoli.com)

- |   |                              |                                   |  |
|---|------------------------------|-----------------------------------|--|
| 1 Hammer Case Lock Washer               | 13 Motor Housing             | 26 Vane                           | 39 Trigger Pin                         |
| 2 Hammer Case Cap Screw                 | 14 Front Rotor Bearing       | 27 Rotation Reverse Shaft         | 40 Trigger                             |
| 3 Hammer Case                           | 15 Front End Plate           | 28 Rotation Reverse Shaft Seal    | 41 Rotation Reverser Pin               |
| 4 Hammer Case Bushing                   | 16 Front Cylinder Dowel      | 29 Rotation Reverse Shaft Bushing | 42 Rotation Reverser Spring            |
| 5 3/4" Socket Retaining Ring            | 17 Cylinder                  | 30 Silencer                       | 43 Rotation Reverser Grub Screw        |
| 6 3/4" Socket Retainer O-ring           | 18 Rotor                     | 31 Anchor Pin Circlip             | A Whole Motor Housing (13;27+29;31+43) |
| 7 Standard Anvil Shank (3/4"sq. drive)  | 19 Rear Cylinder Dowel       | 32 Air Filter                     | B Whole Hammer Case (3;4)              |
| 7L Extended Anvil Shank (3/4"sq. drive) | 20 Housing Cover Gasket      | 33 Valve Spring                   | C Front End Plate + Bearing (14;15)    |
| 8 Hammer Frame                          | 21 Housing Cover Screw       | 34 Stainless Ball                 | D Rear End Plate + Bearing (24;25)     |
| 9 Hammer                                | 22 Housing Cover Lock Washer | 35 Valve Seat                     | E Air Inlet Valve (31+36)              |
| 10 Hammer Pin                           | 23 Housing Cover             | 36 Air Inlet Reducer              | F Anvil Shank +Ring +O-ring (5;6;7/7L) |
| 11 Hammer Case Rear Washer              | 24 Rear Rotor Bearing        | 37 Valve Pin                      |  |
| 12 Hammer Case Gasket                   | 25 Rear Plate Bearing        | 38 Valve Pin Bushing              |  |